

Superior

RECREATIONAL PRODUCTS

A PLAYCOR COMPANY



Dog Play

2021 PRODUCT GUIDE



For Dogs *and their owners!*

Dogs were born for activity, so many behavior problems are caused by a lack of physical and mental activity. Our dog park products provide opportunities to exercise their minds and bodies by catering to dogs of all abilities and confidence levels. Enhancing your dog park with our products will make every day a paw-tay!



We Use Quality *dog park materials*

At Superior, we only use quality materials for your dog park — whether purchasing just a **bench** or a **full dog park package**. Our dog park products are proudly **made in the USA**. Our products are built to last and provide fun for years to come.

1

We offer the look and feel of wood without the unwanted maintenance.

Our recycled posts and decks look just like wood without the unwanted maintenance. These reinforced posts and decks are vandal resistant, protected from rotting or splitting, and have UV additives to protect them from fading. Additionally, this material is resistant to termites, salt spray, and corrosion.

2

Our rotationally-molded plastics have anti-static inhibitors.

Our rotationally-molded plastics, such as those used for tubes and roofs, are made of ¼" thick low density polyethylene (LDPE). They are UV stabilized for reduced fading and also contain anti-static inhibitors.

3

Our powder coat leaves your equipment protected.

Our steel accents are primed at the welded areas and coated with 3-5 mils of powder coat to protect your equipment from fading and rust. Additional extra-protection coating options for regions, such as coastal, are available.

4

Our textured HDPE panels are strong and UV stabilized.

Our ¾" thick textured high density polyethylene is used for our panel accents, such as on our Dog Log. With UV stabilization, we ensure your carefully selected color will remain bright and colorful for years to come. These panels are stain- and graffiti-resistant and will not splinter or crack.

5

Our shade fabric blocks the sun's harmful UV rays.

Our shade fabric blocks 91%-99% of harmful UV rays, depending upon the color you've chosen. Our fabric is also flame retardant, with some of our color choices being California Fire Marshal certified.

6

We offer stainless steel hardware, so you won't worry about rust.

99% percent of the hardware we use on our dog play equipment is stainless steel, with less than 1% being corrosion-resistant coated steel. Our hardware is packaged individually and labeled, allowing for more efficient installation.

Dog Play Packages

Our packages are designed to keep pets active and healthy, while being cost effective. From the most basic to the most advanced, our packages will keep tails wagging. Each package includes a collection of our products at a discounted price just for you. Dig deep into our offerings to find the one that best suits your needs.

DOG'S BEST FRIEND



Model: RECF0017XX

Recommended Area: 28' x 33'

Includes:

- A. Dog Log
- B. Jump Through
- C. Home Sweet Home
- D. High Jump
- E. Stepping Up
- F. Climb and Sit



MASTER COMPANION



Model: RECF0016XX

Recommended Area: 44' x 34'

Includes:

- A. Dog Log
- B. Walk the Plank
- C. Over and Under
- D. Limbone Anyone
- E. Home Sweet Home
- F. Through the Target



Indicates Skill Level of Course on 3-Point Scale

Dog Play Packages

PUPPY PARADISE

Model: RECF0018XX

Recommended Area: 32' x 37'

Includes:

- A. Jump Through
- B. Home Sweet Home
- C. Stepping Up
- D. Let's Rest
- E. Camel Hump Climber
- F. Nice Turn



PAWSITIVELY PLAYFUL

Model: RECF0019XX

Recommended Area: 30' x 27'

Includes:

- A. Stepping Up
- B. Home Sweet Home
- C. Nice Turn
- D. Jump Through



Dog Play Packages

BEGGIN' FOR MORE

Model: RECF0020XX

Recommended Area: 35' x 64'

Includes:

- A. Jump Through
- B. Walk the Plank
- C. High Jump
- D. Let's Rest
- E. Dog Log
- F. Stepping Up
- G. Home Sweet Home
- H. Through the Tunnel
- I. Over and Under
- J. Camel Hump Climber



BEST IN SHOW

Dogs of all sizes and abilities will be able to enjoy this course. This product package is the best-of-the-best because it includes each of our products.

Model: RECF0021XX

Recommended Area: 51' x 52'

Includes:

All Dog Play components shown on pages 6-7 except the Leash Holder.



Dog Play Components

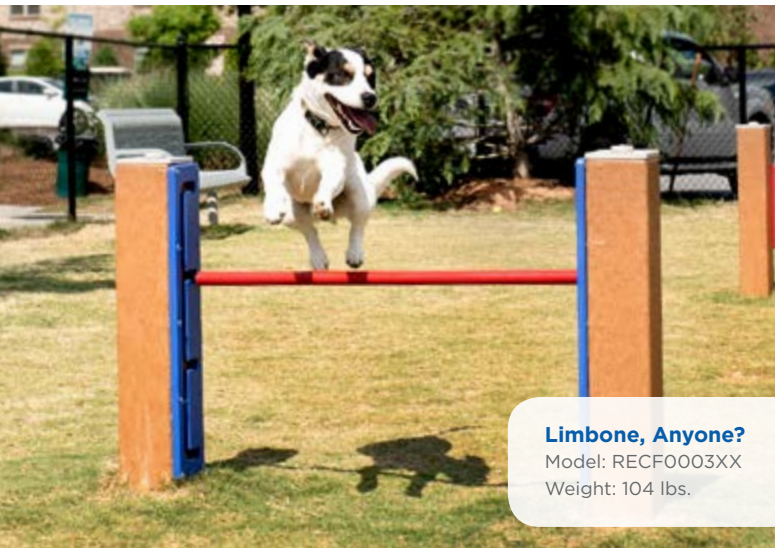

Limbone, Anyone?
Model: RECF0003XX
Weight: 104 lbs.



Hurdle Jump
Model: RECF0007XX
Weight: 68 lbs.
Sold as a set of 4

Dog Play Components



Home Sweet Home
Model: RECF0010XX
Weight: 416 lbs.

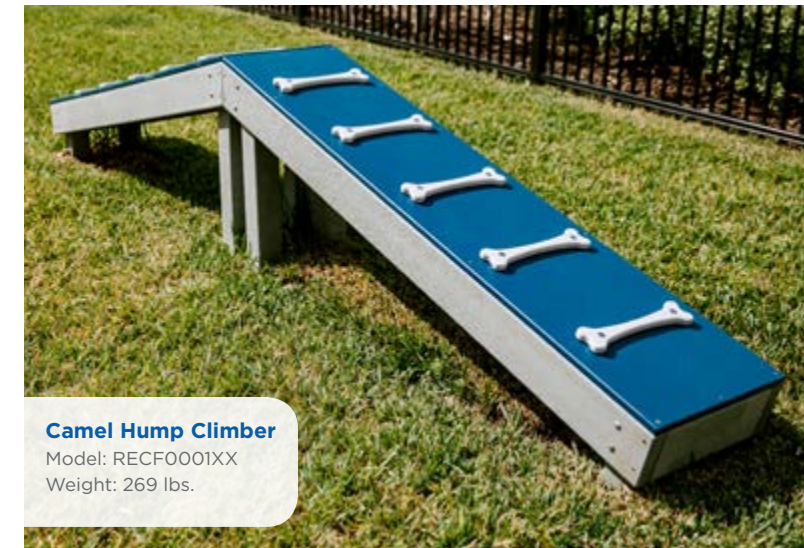

Camel Hump Climber
Model: RECF0001XX
Weight: 269 lbs.



High Jump
Model: RECF0011XX
Weight: 128 lbs.



Over and Under
Model: RECF0012XX
Weight: 109 lbs.



Through the Target
Model: RECF0006XX
Weight: 112 lbs.



Through the Tunnel
Model: RECF0004XX
Weight: 420 lbs.



Nice Turn
Model: RECF0013XX
Weight: 331 lbs.



Dog Log
Model: RECF0008XX
Weight: 400 lbs.



Jump Through
Model: RECF0014XX
Weight: 147 lbs.



Walk the Plank
Model: RECF0015XX
Weight: 347 lbs.



Leash Holder
Model: RECF0022XX
Weight: 70 lbs.



Step Up
Model: RECF0005XX
Weight: 154 lbs.



Let's Rest
Model: RECF0009XX
Weight: 246 lbs.



Climb and Sit
Model: RECF0002XX
Weight: 296 lbs.

Site Amenities



Standard Dog Park Bench

SPECIFICATIONS

- 6' bench
- Available with paws or bone design
- 2 3/8" powder coated frame
- Add P (portable), SM (surface mount), or S (in-ground mount) to end of product number
- Textured polyethylene seat and seat back
- 10" seat width and 17" seat height

METAL DESIGN	PRODUCT NO.
UltraLeisure®	B6WBUL
UltraLeisure® Perforated	B6WBULPERF



Classic Dog Park Bench

SPECIFICATIONS

- 6' bench
- Available with paws or bone design
- Cast aluminum, powder coated frames
- Portable with pre-drilled holes for optional surface mounting
- Contoured back
- Textured polyethylene seat and seat backs
- 16 1/2" seat height
- Classic wave design

PRODUCT NO.: B6WBCLASSIC



Classic Wingline Dog Park Bench

SPECIFICATIONS

- 6' bench
- Available with paws or bone design
- Heavy-duty 2 3/8" powder coated frames
- Add P (portable), SM (surface mount), or S (in-ground mount) to end of product number
- Contoured back with armrests
- Textured polyethylene seat and seat back
- Seat height is 18"

PRODUCT NO.: B6WBCLASSICWINGLINE

STANDARD DESIGN CHOICES



To denote your desired design, please add -PWS (paws) or -BNS (bones) to the end of each product number after mounting option has been applied.

Site Amenities



Dog Park Trash Receptacle

SPECIFICATIONS

- 32 gallon
- Available with paws or bone design
- Lid and liner sold separately
- Surface and in-ground mount options sold separately
- Textured polyethylene coated

METAL DESIGN	PRODUCT NO.
Regal	TR32
Perforated	TR32PERF
Classic	TR32CLASSIC



Dog Park Drinking Fountains

PET AND OWNER | BSW-0007XX

- Stainless steel
- Meets ADA requirements
- For both humans and pets

PET ONLY | BSW-00100XX

- Stainless steel
- Push-button mechanism
- Anti-rotation non-squirt bubbler



Pet Wash Station

SPECIFICATIONS

- Stainless steel with green powder coat
- Resistant to sunlight, heat, and moisture
- Surface mount
- Hooks to external hose

PRODUCT NO.: BSW-0011XX



Pet Waste Station

SPECIFICATIONS

- Features "Pet Waste Station" sign
- Available in natural or primary color scheme
- Includes sign, bag dispenser box with key, 400 bags, waste receptacle, and mounting post

PRODUCT NO.: BSO-0001XX



Custom Logo, Emblem, or Insignia Amenities

Add your logo, emblem, insignia, or theme to market your dog park. We offer lettering from our selection of fonts, as well as more intricate designs.

DETAILS

- Upcharge per piece
- Powder coated backing plates are available for an additional charge
- Customization available on most products

Natural Elements

Our nature play products provide the same challenges and exercise as our dog play components but with a more natural look. These pieces are made from high quality Glass Fiber Reinforced Concrete (GFRC) but look and feel real!

A. 4' Log Tunnel

Model: 4LT
Space Required: 15' 5" x 15' 8"



B. 6' Half Log Beam

Model: 6HL
Space Required: 18' x 14'



C. Tree Slices

Model: 5TSL
Space Required: 13' 9" x 21' 7"
Includes: 2 Small and 3 Large Steps

D. Stepping Boulders

Model: UP501
Space Required: 13' 11" x 20'
Includes: 2 Small and 1 Large Boulder

Surfacing

For a dog park that requires little maintenance, consider installing one of our surfacing options in lieu of natural grass. The surfacing options below are specifically chosen for the safety of your dog park's furry visitors.

E. Engineered Wood Fiber

- Affordable
- Non-toxic and does not contain paint, chemicals, or additives
- Contains minimal bark and is free of twigs, leaf debris, and other organic material



F. Pup Turf

- Extra strength against wear from paws and claws
- Envirofill Microban Protection to help fight the spread of bacteria
- Safe for the environment, humans, and pets
- Perforated turf layer provides for rapid drainage
- Odors easily flush away with water



Hip End Shelter



Square Shelter



Hip Shade

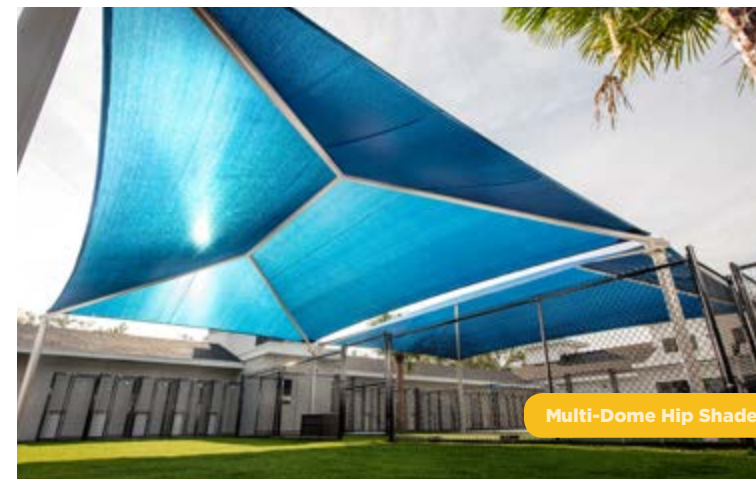

Multi-Dome Hip Shade

Complete Your Space Shade & Shelter

Our fabric shade structures are available in a variety of sizes and styles with our unique Glide Elbow™ mechanism. Similarly, our all-steel shelter collection is available in a variety of sizes and styles that create a unique outdoor gathering area.

Benefits of Shade & Shelter

- Provide UV protection to both dogs and owners
- Extend the life of dog play equipment
- Create a comfortable gathering space within your park or community

Dog Park Shelter

We offer a full line of all-steel shelters that are suitable for picnic areas, bench seating, and more. Have something in mind? Visit srpshelter.com/request-catalog to view the complete catalog.

Dog Park Shade

We have over 30 rectangle and square shades for your dog park. These designs are available in a variety of colors to match any play environment and are a great economical choice. Visit srpshade.com/request-catalog to view the complete catalog.

WE HAVE MANY MORE
styles to choose from!

Color Options

Metal Colors

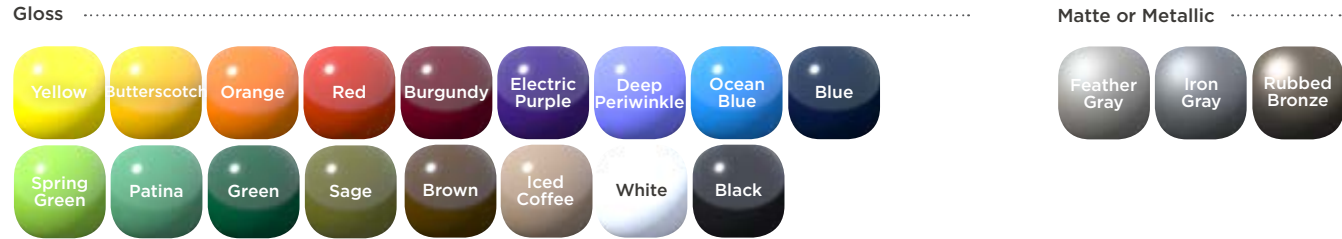

Plastic Colors



Activity Panel & Panel Colors



Recycled Deck & Post Colors



Shade Colors | More Available!



Site Amenities | Textured Polyethylene



Site Amenities | Metal Designs

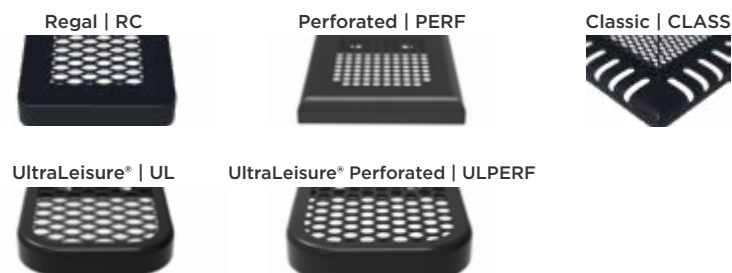

Warranty

LIMITED WARRANTY

Superior Recreational Products (SRP) warrants that its product will be free from defects in materials and workmanship as well as maintain structural integrity for the periods listed below from the date of invoice and once SRP has been paid in full. This warranty is in effect only if the product has been assembled and installed strictly in accordance with the setup instructions provided by SRP, good construction practices, and has been subjected only to normal use and exposure.

- Lifetime* Warranty on steel posts, recycled posts, and stainless steel hardware
- 15-Year Limited Warranty on roto-molded plastics, HDPE plastic sheets, and recycled decks
- 10-Year Limited Warranty on shade fabric
- 7-Year Limited Warranty on textured polyethylene and thermoplastic
- 5-Year Limited Warranty on frames and powder coat
- 1-Year Limited warranty on nature products, moving parts, and materials not covered above

The Limited Warranty excludes abnormal conditions, contingent liability, cosmetic defects such as scratches, dents, marring, stripping, peeling, or fading; damage due to incorrect installation, vandalism, misuse, accident wear and tear from normal use; exposure to extreme weather, immersion in salt or chlorine water, damage due to sand, salt spray, or other abrasive and corrosive material; unauthorized repair or modification, abnormal use, or lack of maintenance. The warranty does not cover damages due to "acts of God" such as hail, flooding, lightning, tornadoes, sand storms, shifts of terrain, earthquakes, mud slides, and windstorms. SRP does not warrant product for defects caused by erection, harsh site conditions, lack of maintenance, and/or other conditions beyond SRP's control. SRP will not be held responsible for any materials that were not properly stored prior to installation. SRP reserves the right to void the limited warranty if not installed per the installation instructions and/or unauthorized modifications.

In the unlikely event of failure, SRP reserves the right to alter the design, color, or contributing factors to rectify the condition and help prevent any future reoccurrence(s). SRP has the option to repair or replace any defect in materials.

The warranty is void if any changes, modifications, additions, or attachments are made to the product without the written consent of the manufacturer.

SRP excludes any implied warranty of merchantability, fitness, or purpose, and there are no warranties which extend beyond the description of the face hereof. Under no circumstances will SRP be responsible for any indirect, special, consequential, incidental, or liquidated damages due to breach of warranty and such damages are specifically excluded from the warranty.

The owner shall notify SRP with original Sales Order Number issued from SRP to arrange for an inspection within 30 days after discovery of any defect under this warranty and before any alteration or repair is made or attempted. This Limited Warranty shall be null and void if the owner makes any alterations in design.

This warranty is the only express warranty given by the company. No person has authority to change or add to these obligations and liabilities. The company reserves the right to determine whether the fault is caused by faulty workmanship, material, or the part that is defective.

SRP will repair or replace at its discretion any defective part/s on an Ex-Works basis only. It is the responsibility of the customer to return the whole unit or the defective part/s at their own cost back to SRP for inspection along with proof of the date of purchase. SRP will not be liable for any costs incurred by the customer as a result of replacing the defective part/s, including but not limited to the costs of site visits and the labor costs involved with the removal and reinstallation of the whole unit or the defective part/s. Furthermore SRP will not be liable for any claimed compensation while the unit is not working or not present at the site whatsoever. This guarantee does not entitle the customer to a complete new product due to a defective component.

*For the purpose of this warranty, lifetime encompasses no specific term of years, but rather that seller warrants to its original customer for as long as the original customer owns the product and uses the product for its intended purpose that the product and all parts will be free from defects in materials and manufacturing workmanship. This warranty does not cover damage caused by vandalism, misuse or abuse, altered or modified parts, or cosmetic damage such as scratches, dents, or fading or weathering and normal wear and tear. This warranty is valid only if the structures are installed in conformity with instructions provided by Superior Recreational Products using approved Superior Recreational Products parts. Superior Recreational Products will deliver the repaired or replacement part or parts to the site free of charge, but will not be responsible for labor or the labor costs of replacement. Warranty claims must be filed within the applicable warranty period and accompanied by a sales order or invoice number.



Structural Steel SRP offers a 5-year limited warranty on structural supports for tables and benches to the original purchaser to be free of rust outs that would compromise structural integrity. Workmanship is warranted for a period of five years. This steel warranty shall be void if damage to the steel is caused by the installer or from physical damage, damage by salt spray or sprinkler systems, contact with chemicals, chlorine, pollution, misuse, vandalism, or any act of God.

Powder Coat SRP offers a 5-year Limited Warranty for powder coating to the original purchaser. This Limited Warranty is for factory applied finish only. Damage occurring from shipping, erection, vandalism, accidents, or field modification is not covered in this limited warranty and will require field touch-up immediately and periodically thereafter. The owner must report any defect in powder coat at the time the installation is completed. Not covered by this Limited Warranty are acute angles, welds, and end plates.

The Limited Warranty for powder coating provides the following after a 5-year exposure period when applied according to the recommendations listed on the product's technical data sheet and appropriate surface preparation has been utilized.

- The coatings shall retain their original color with a ΔE of <7.5 units for high chroma colors (yellows, reds, oranges, etc.) and a ΔE of <5.0 units for low chroma colors, when tested in accordance with ASTM D 2244.
- The coating shall retain a minimum of 50% of its original gloss level after washing, when tested in accordance with ASTM D 523.
- The coating shall exhibit chalking no worse than numerical rating of 6, when evaluated in accordance with ASTM D 659-80.

Textured Polyethylene & Thermoplastic SRP offers a 7-year limited warranty to the original purchaser of the products to be free of corrosion on seats and tops that results in bare metal exposure after the date of purchase, excluding any corrosion that may be the result of vandalism or intentional stripping of any of the coating.

Pricing, Cancellation, and Shipping Policy All prices are F.O.B. factor and do not include freight, installation, shipping and handling, surfacing, or applicable taxes. All prices listed were current at the time of printing and in U.S. currency. Prices are subject to change without notice. To view our return policy, please visit superiorrecreationalproducts.com/returns. To view our shipping policy, please visit superiorrecreationalproducts.com/shipping. For further information any further information please call 1.800.327.8774.

TOP AND SEAT COATING

Our powder-based textured polyethylene is placed in a fluidized vat where the product is dipped and then baked. Traditionally, polyethylene is very easily scratched and marred causing it to be difficult to fix. By using a textured surface, SRP has eliminated this problem. Our textured polyethylene coating helps hide the scratches and marks, while keeping the product looking better longer. This coating is maintenance-free.

FEEL	Harder Feel	APPLICATION	Outdoor/Indoor
THICKNESS	Approx. 1/8" Thick	ANTI-FUNGUS	Yes
DRIPS	No	FINISH	Textured Finish
UV PROTECTION	Yes		





3800 Edinburg Drive
Murrysville, PA 15668

15005 Scenic Ridge Drive
James Creek, PA 16657

833.4.PLAYGO
(833.475.2946)
playgoco.com

